

Published : Aug 2, 2005

Front Seat Backrest Cover (78.90.08)

Removal

1. Make the SRS system safe. For additional information, refer to [Standard Workshop Practices](#) (Section 100-00)
2. Remove the front safety belt buckle. For additional information, refer to [Front Safety Belt Buckle \(76.73.30\)](#) (Section 501-20)
3. Remove the front seat cushion side trim.
 - Remove the 2 screws.
 - Release from the 3 clips.

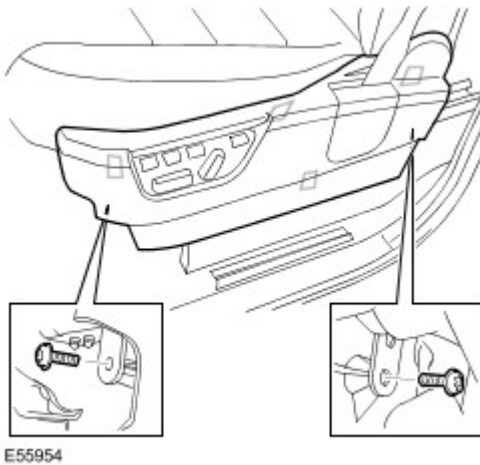

4. Remove the seat backrest hinge cover.
 - Remove the 2 screws.
 - Release from the clip.

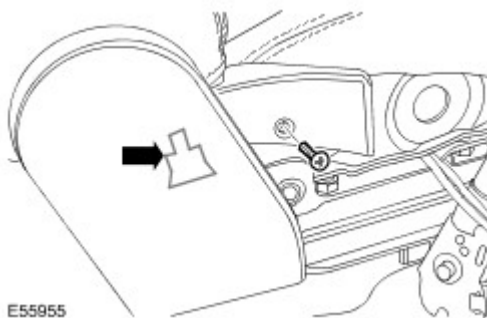

5. Remove the front seat backrest assembly.
 - Release the retaining clips and disconnect the three electrical connectors.
 - Remove the 4 Torx bolts.

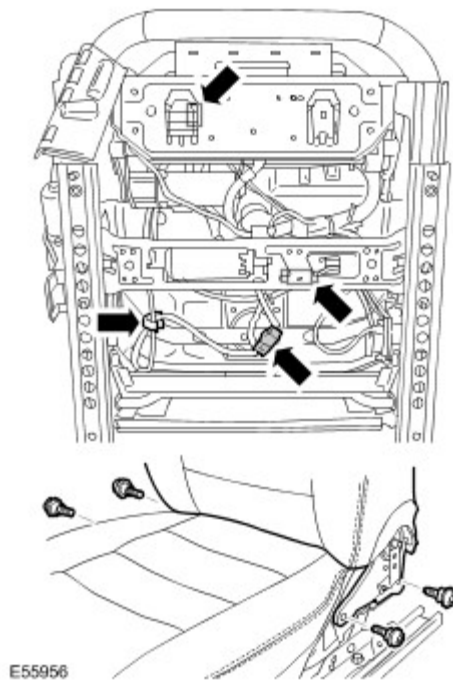

- 6 . Remove the front seat grab handles.
- Remove the bolt covers.
 - Remove the 2 bolts.



- 7 . **NOTE :**
Head restraint release latch is underneath backrest cover.
Remove the front seat head restraint.
- Release the front seat head restraint latch.

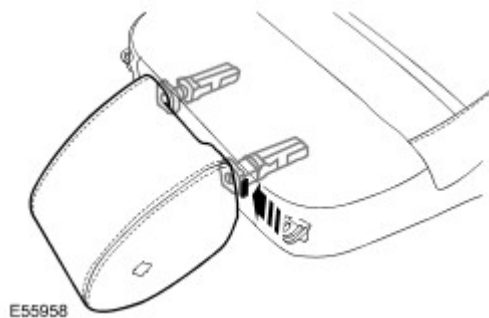

- 8 . Remove the front seat armrest.
- Remove the bolt cover.
 - Remove the Torx bolt.

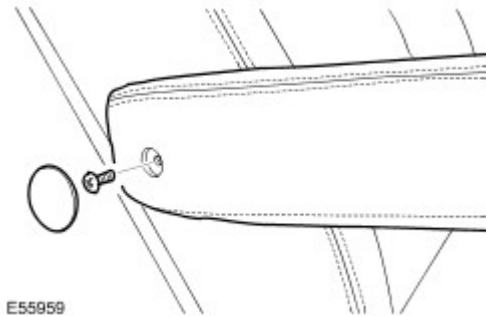

- 9 . Remove the front seat lumbar adjustment knob.
- Pull sharply to release from lumbar mechanism.



- 10 . Release the front seat backrest cover.
- Release the 5 clips.
 - Release the tension straps.

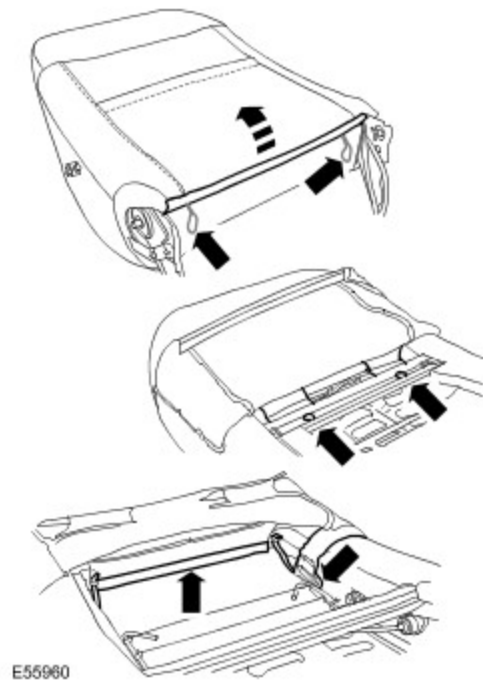

- 11 . Remove the front seat backrest cover.

➤ Remove the 3 hog rings.



Installation

- 1 . Install the front seat backrest cover.
 - Install the hog rings.
 - Install the clips.
 - Attach the tension straps.
- 2 . Install the front seat lumbar adjustment knob.
 - Push firmly to secure to the lumbar mechanism.
- 3 . Install the front seat armrest.
 - Tighten the Torx bolt to 10 Nm (7 lb.ft).
 - Install the bolt cover.

- 4 . Install the front seat head restraint.
- 5 . Install the front seat grab handles.
 - ▶ Tighten the bolts to 25 Nm (18 lb.ft).
 - ▶ Install the bolt covers.
- 6 . Install the front seat backrest assembly.
 - ▶ Tighten the Torx bolts to 25 Nm (18 lb.ft).
 - ▶ Connect and secure the electrical connectors.
- 7 . Install the seat backrest hinge cover.
 - ▶ Tighten the screws.
 - ▶ Fit the clip.
- 8 . Install the front seat cushion side trim.
 - ▶ Position and secure in the clips.
 - ▶ Install the screws.
- 9 . Install the front safety belt buckle. For additional information, refer to [Front Safety Belt Buckle \(76.73.30\)](#) (Section 501-20)